

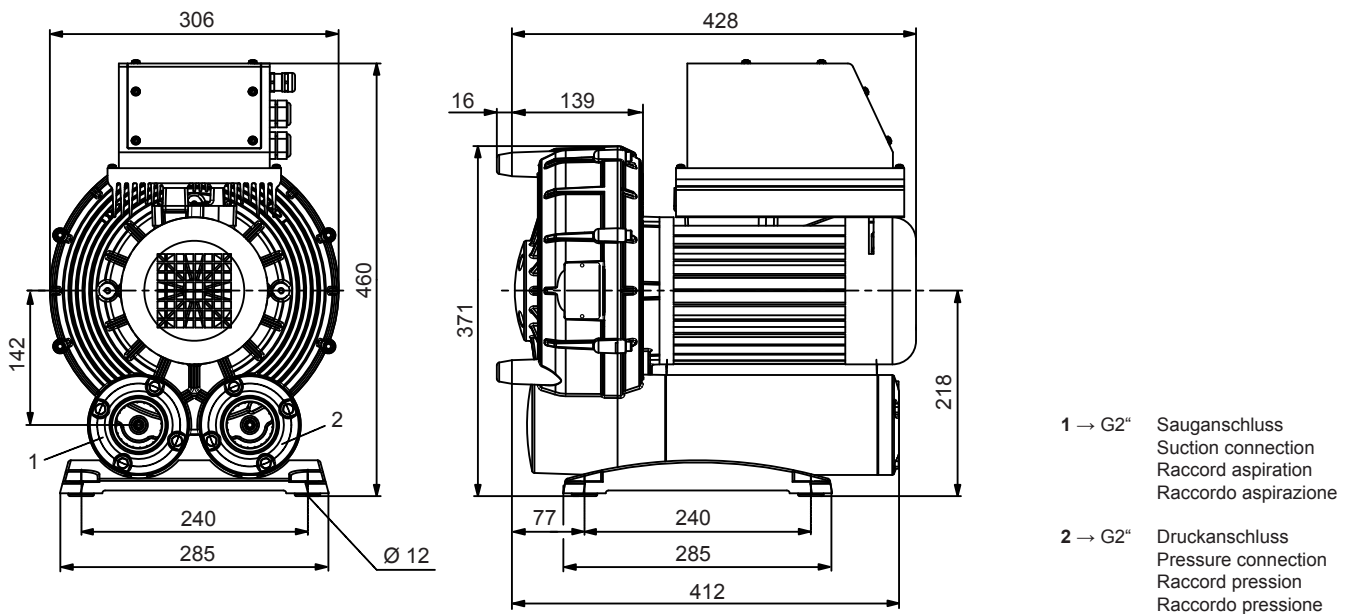



Seitenkanal-Verdichter, einstufig, luftgekühlt, mit Frequenzumrichter
Side channel blowers, single stage, air-cooled, with frequency inverter
Compresseurs à canal latéral, mono-étagées, refroidies par air, avec convertisseur de fréquence
Soffianti a canale laterale, monostadio, raffreddate ad aria, con convertitore di frequenza (inverter)



VARI-AIR UNIT	m³/h (max.)	mbar (max. rel. ¹⁾)	kW 3~	Hz	dB(A)²⁾	kg
SV 8.190/1-401	320	+260	4,0	0 - 100	71	35

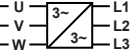

 → 3~ • 4,0 kW • 400 - 480 V ± 10% • 50/60 Hz • ≤ 5780 min⁻¹

 → 16 A

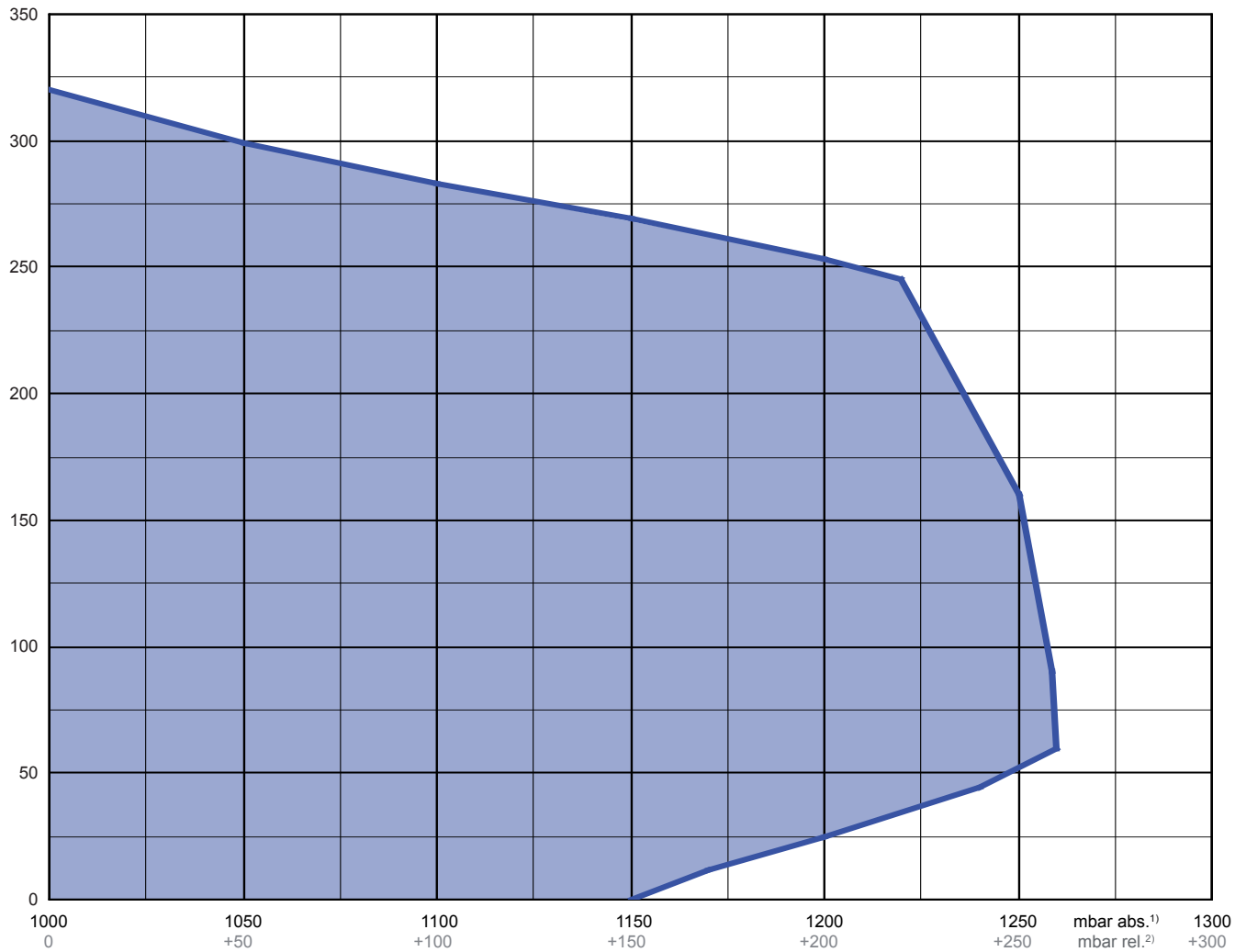
1) mbar relativ • mbar relative • mbar relatif • mbar relativo → mbar absolut (absolute • absolu • assoluto) = 1000 + (±x mbar rel.)
 2) bei mittlerer Belastung (+130 mbar / 150 m³/h), beide Seiten abgeleitet • at medium load (+130 mbar / 150 m³/h), both sides derived • à régime moyen (+130 mbar / 150 m³/h), les deux côtés dérivés • a medio regime (+130 mbar / 150 m³/h), entrambi i lati derivati : DIN EN ISO 2151 + DIN EN ISO 3744 (KpA = 3 dB(A))

m³/h Blasluftmenge • Blast air rate • Débit d'air soufflé • Volume d'aria soffiata

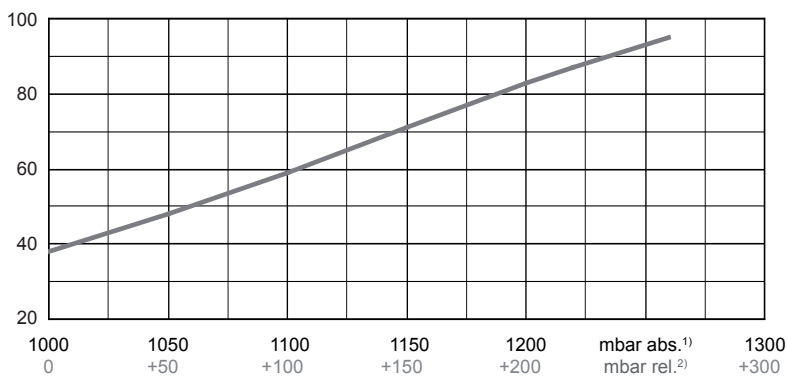

°C Max. Drucklufttemperatur • Max. temperature compressed air
Max. température air comprimé • Mas. temperatura aria compressa



kW Max. Wellenleistung • Max. motor shaft capacity
Max. puissance du moteur axe • Mas. potenza del motore albero

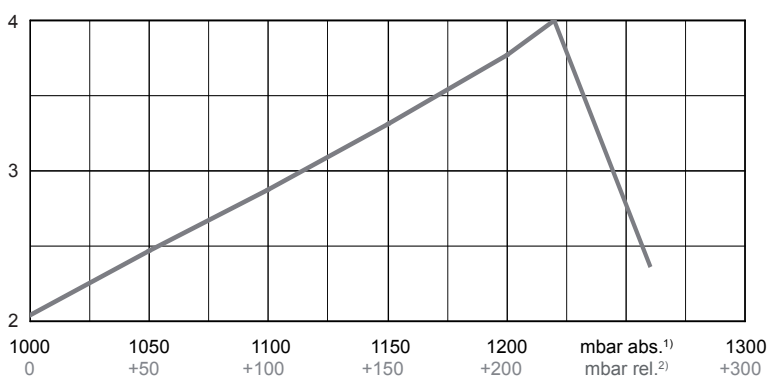

VARIAIR
UNIT

SV 8.190/1-401

1) mbar absolut • mbar absolute • mbar absolu • mbar assoluto
2) mbar relativ • mbar relative • mbar relatif • mbar relativo

Bezugsdaten (Atmosphäre) • Reference (atmosphere) • Référence (atmosphère) • Riferimento (atmosfera) : 1000 mbar, 20°C

Mögliche Abweichung • Allowable tolerance • Variation possible • Variazione possibile : ±10 %